

CLAUDE MIRROR

ASSEMBLY INSTRUCTIONS

Hanging Kit includes:

1. Screw – 2 pcs
2. Wall anchor – 2 pcs



CAUTION

This product is heavy. Please use two strong fixing points to hang this picture frame. Please ensure the wall plugs and screws provided are suitable to the type of wall construction (eg: stone, brick, cavity) the mirror is to be hung from and the wall is suitable for holding the weight of the mirror. If in doubt, seek professional advice.

This picture frame has been designed to be hung as shown below

Failure to follow these directions may result in a safety hazard.

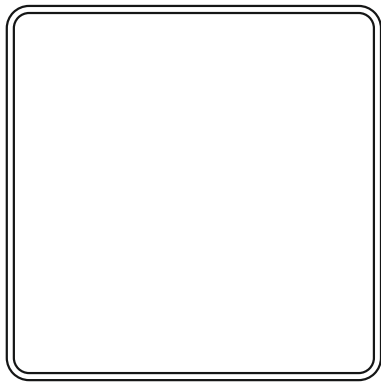

Front View

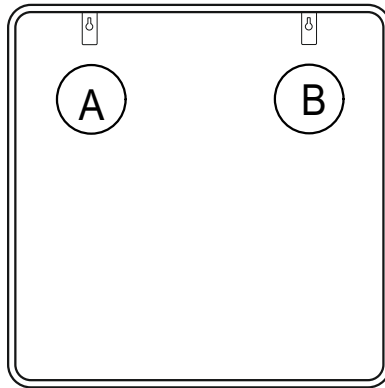

Back of mirror

Step 1. Measure the distance between the D-rings/hanging brackets (A & B)

Step 2. Measure the same distance on the wall, ensuring that the two points are level & mark the wall where the frame is to be hung A & B

Step 3. Drill holes at A & B for the wall anchors & insert wall anchors

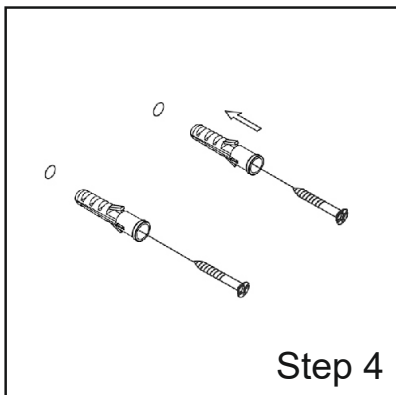

Step 4

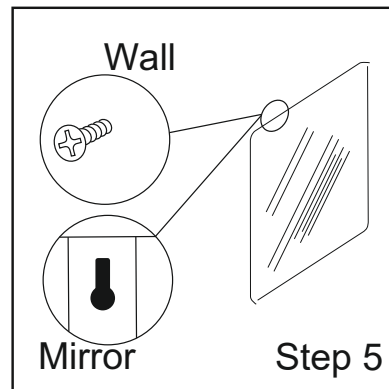

Mirror

Step 5

Step 4. Insert the screws into the wall anchors, leaving enough of the screw head protruding from the wall anchor to accept the D-ring/hanging bracket (see image)

Step 5. The D-ring should be hung directly onto the screws